

Screw-in resistance thermometer form C according to DIN 43763

with neck tube, the sensor tube 14 x 2.5 mm

Measuring insert 1 x PT 100 / 2 x PT 100, changeable 8 mm Ø
 2- 3- or 4-wire technology
 Transmitter installation possible (Sheet 18.10)

Connection head Form B of light alloy according to DIN 43729 with
 M 20 x 1.5 cable entry

Connection diagram See sheet 19.20

Operating temperature according to chart sheet 1.1

Response time (Average value)
 in Water 0,4 m/s : $t_{0,5} \approx 40$ s, $t_{0,9} \approx 120$ s
 in Air 1 m/s : $t_{0,5} \approx 3,2$ min, $t_{0,9} \approx 7,8$ min

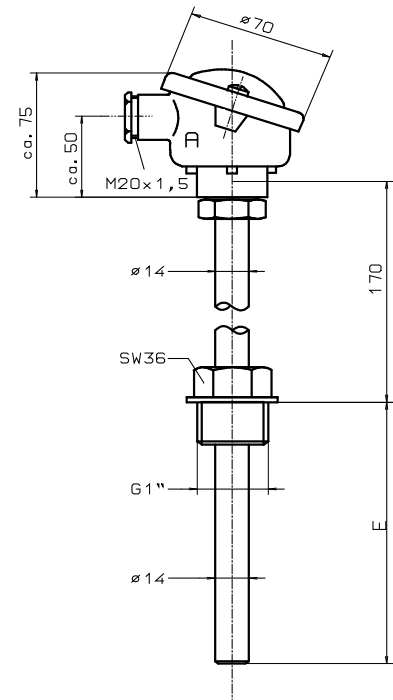
Version

 Sensor tube to DIN 43763 Form C, Thermowell 14 x 2.5 mm, 8 mm Ø exchangeable measuring insert
 1.4541 stainless steel (V2A) X6 CrNiTi 1810

Thermowell Material	E in mm	Weight in kg	Measuring insert length	Order no. 1 x PT100	Order no. 2 x PT100	Delivery time
1.4541	100	1,2	255	4.12.04.41	4.12.04.42	All models are available by arrangement
	160	1,3	315	4.12.04.11	4.12.04.12	
	250	1,4	405	4.12.04.21	4.12.04.22	
	300	1,5	455	4.12.04.51	4.12.04.52	
	400	1,7	555	4.12.04.31	4.12.04.32	
	500	1,8	655	4.12.04.61	4.12.04.62	
	600	1,9	755	4.12.04.71	4.12.04.72	
	800	2,2	955	4.12.04.81	4.12.04.82	
	1000	2,5	1155	4.12.04.91	4.12.04.92	
	Surcharge		3- wire circuit	4.12.00.03	4.12.00.23	
			4- wire circuit	4.12.00.04	4.12.00.24	

Version

 Sensor tube to DIN 43763 Form C, Thermowell 14 x 2.5 mm, 8 mm Ø exchangeable measuring insert
 1.4571 stainless steel (V4A) X6 CrNiTi 1810

Thermowell Material	E in mm	Weight in kg	Measuring insert length	Order no. 1 x PT100	Order no. 2 x PT100	Delivery time
1.4571	100	1,2	255	4.12.20.41	4.12.20.42	All models are available by arrangement
	160	1,3	315	4.12.20.11	4.12.20.12	
	250	1,4	405	4.12.20.21	4.12.20.22	
	300	1,5	455	4.12.20.51	4.12.20.52	
	400	1,7	556	4.12.20.31	4.12.20.32	
	500	1,8	655	4.12.20.61	4.12.20.62	
	600	1,9	755	4.12.20.71	4.12.20.72	
	800	2,2	955	4.12.20.81	4.12.20.82	
	1000	2,5	1155	4.12.20.91	4.12.20.92	
	Surcharge		3- wire circuit	4.12.00.03	4.12.00.23	
			4- wire circuit	4.12.00.04	4.12.00.24	

Versions in other nominal lengths and materials possible