

Immersion Resistance thermometer

Sensor tube 10 x 1.5 mm, screw slidable

Measuring insert 1 x PT 100 / 2 x PT 100, changeable 6 mm Ø
 Transmitter installation possible (Sheet 18.10)

Connection head Form B of light alloy according to DIN 43729 with
 M 20 x 1.5 cable entry

Connection diagram See sheet 19.20

Operating temperature Up to 550° C

Response time (Average value)
 in Water 0,4 m/s : $t_{0,5} \approx 20$ s, $t_{0,9} \approx 60$ s
 in Air 1 m/s : $t_{0,5} \approx 2,0$ min, $t_{0,9} \approx 6,0$ min

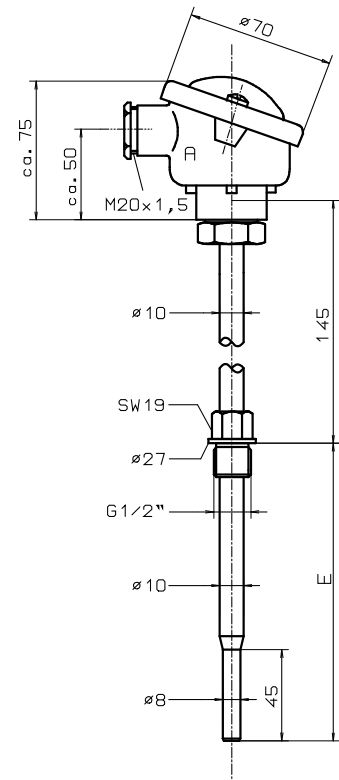

Version Material 1.4541 (V2A) stainless steel X6 CrNiTi 1810

Thermowell Material	E in mm	Weight in kg	Measuring insert length	Order no. 1 x PT100	Order no. 2 x PT100	Delivery time
1.4541	50	1,0	205	4.32.04.41	4.32.04.42	All models are available by arrangement
	100	1,1	255	4.32.04.51	4.32.04.52	
	160	1,2	315	4.32.04.11	4.32.04.12	
	200	1,2	355	4.32.04.61	4.32.04.62	
	250	1,3	405	4.32.04.21	4.32.04.22	
	300	1,3	455	4.32.04.71	4.32.04.72	
	350	1,4	505	4.32.04.81	4.32.04.82	
	400	1,4	555	4.32.04.31	4.32.04.32	
	500	1,6	655	4.32.04.91	4.32.04.92	
	Surcharge		3-wire circuit	4.32.00.03	4.32.00.23	
			4-wire circuit	4.32.00.04	4.32.00.24	

Version Material 1.4571 (V4A) stainless steel X6 CrNiMoTi 17222

Thermowell Material	E in mm	Weight in kg	Measuring insert length	Order no. 1 x PT100	Order no. 2 x PT100	Delivery time
1.4571	50	1,0	205	4.32.20.41	4.32.20.42	All models are available by arrangement
	100	1,1	255	4.32.20.51	4.32.20.52	
	160	1,2	315	4.32.20.11	4.32.20.12	
	200	1,2	355	4.32.20.61	4.32.20.62	
	250	1,3	405	4.32.20.21	4.32.20.22	
	300	1,3	455	4.32.20.71	4.32.20.72	
	350	1,4	505	4.32.20.81	4.32.20.82	
	400	1,4	555	4.32.20.31	4.32.20.32	
	500	1,6	655	4.32.20.91	4.32.20.92	
	Surcharge		3-wire circuit	4.32.00.03	4.32.00.23	
			4-wire circuit	4.32.00.04	4.32.00.24	

Versions in other stroke lengths and materials possible.